

RoHS
COMPLIANT

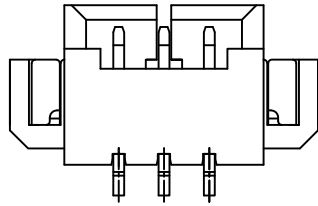

3 Circuits

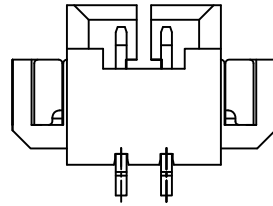

2 Circuits

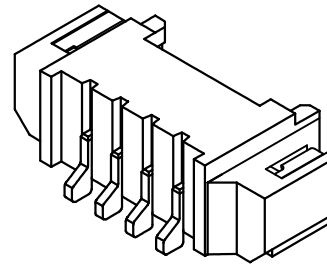

◆ SPECIFICATIONS

- Current rating: 1A AC, DC
- Voltage rating: 125V AC, DC
- Temperature range: -40°C ~ +105°C
- Insulation resistance: 100MΩ Min.
- Withstanding voltage: 250V AC/ minute.
- Contact resistance: 20mΩ Max.

Material:

Insulator: LCP/PA46, UL 94V-0

Contact: Brass

Solder Tab: Brass

Plating: Gold plated or Matte-Tin plated over Nickel

Circuits: 2~16

Suitable: KR1250 series Housing

Ordering Code:

C1250RS 1*** ** 01 * A

102=2P

116=16P

07:PA46 ecru

13:LCP ecru

14:LCP black

R:Reel

P:Bag

M01:Matte tin plating

G02:Gold plated 1u"

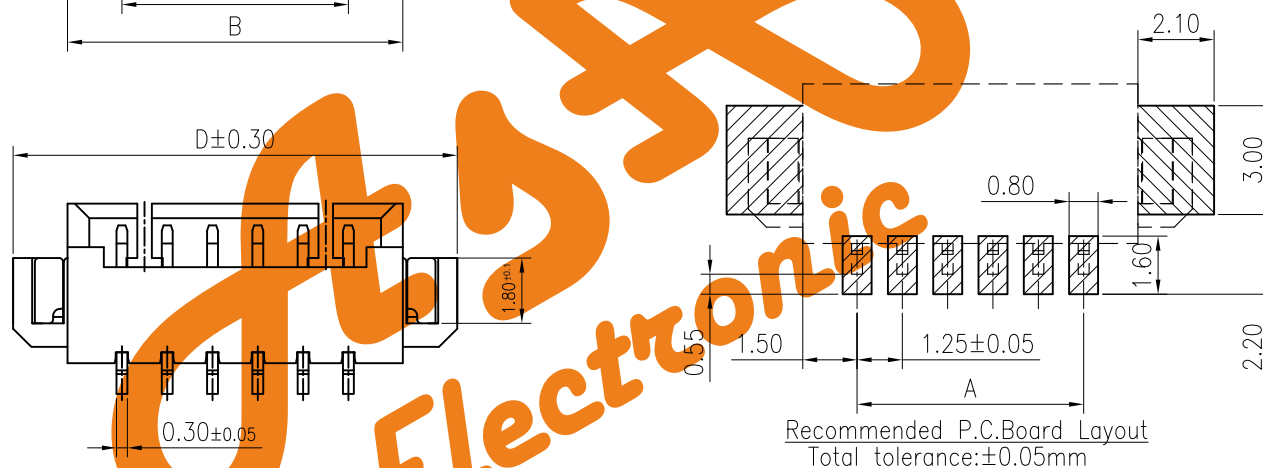
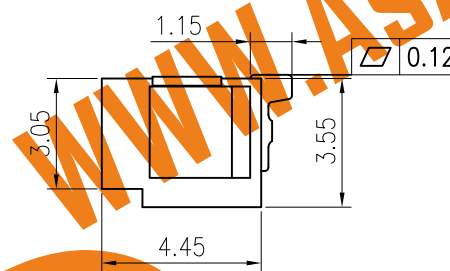
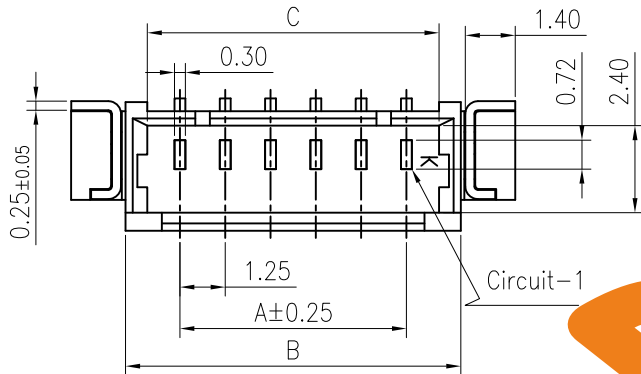

PIN NO.	DIMENSIONS			
	A	B	C	D
2	1.25	4.25	3.05	7.25
3	2.50	5.50	4.30	8.50
4	3.75	6.75	5.55	9.75
5	5.00	8.00	6.80	11.00
6	6.25	9.25	8.05	12.25
7	7.50	10.50	9.30	13.50
8	8.75	11.75	10.55	14.75
9	10.00	13.00	11.80	16.00
10	11.25	14.25	13.05	17.25
11	12.50	15.50	14.30	18.50
12	13.75	16.75	15.55	19.75
13	15.00	18.00	16.80	21.00
14	16.25	19.25	18.05	22.25
15	17.50	20.50	19.30	23.50
16	18.75	21.75	20.55	24.75

F		Uniformly arrange the drawings	Shen	2021.08.30	TOLERANCE X.X ±0.30 X.XX ±0.20 X.XXX ±0.10 Angle ±3°	TITLE: 1.25 SMT	DRAWN:	CHECKED:	APPROVED:	 WWW.ASA-Elec.com AsA Electronic Co. Tel : (+98) 21 66 73 56 82 Mob : (+98) 912 03 161 02
		Change the part number and frame format	TLX	2020.03.20						
	MARK	REVISION DESCRIPTION	SIGNATURE	DATE						
	1	2	3	4	UNIT:mm	SCALE:1/1	SHEET:1/1	PROJECTION	REV.:A5	